



Installation Instructions

Complete set active Sound incl. Soundbooster

Mercedes V-KLasse W447

v1.3 (16.06.2017)

Contents

1	Liability Exclusion	3
2	Copy Right	4
3	General Notes	4
4	Safety instructions	5
5	Requirements for the determinable operation	5
6	Note	5
7	How to connect a cable to another	6
8	Note Cable Inscription/Color	7
9	Assembly Instructions	8
10	Connection CAN-High / CAN-Low	9
11	Connection ground / removing center console	10
12	Connection ignition lead / control unit / module	11
13	Removing sill trims front / rear	12
14	Routing cable sound generator	13
15	Routing cable sound generator to the underbody	14
16	Installation sound generator	15
17	Important Information Sound Booster	16

1 Liability Exclusion

Dear Customer

Our cable sets are developed according to the connection- and circuit diagrams of the corresponding car manufacturer. Before the original production the cable sets will be tested on an original car. Therefore, the integration into the car electronics will be executed according to the instructions of the manufacturer. Regarding the necessary pre-understanding and the accuracy of the presentation of texts and pictures our mounting guidelines correspond to the usual ones in car technology and car electronics. Practically, they have been proved one's worth a hundred times.

However, should there be any difficulties during the installation of our products we will be at your disposal any time for support by phone or by mail. Moreover, we offer you to execute the installation at our works in Bad Segeberg.

Costs which may arise because a third person will execute the installation of our products will not be supported by us in any case. Only if there is a mistake caused by our product we will pay the proved costs of the installation as well as the costs of the removal of the defective product. The refund of expenses will be limited to gross EUR 110,- ; we reserve the right to check the described mistake in our works in Bad Segeberg. In case of a proved reclamation the costs for dispatch for the check in our factory will be transferred to you.

According to our experience each specific factory which has the necessary diagnostic device, diagnostic software and the circuit diagrams of the manufacturer can find possible mistakes at our products within a short time. So the installation and removal including diagnostic inspection can be realised in at most 60 minutes.

We also made the experience that many specific factories cannot work with the circuit diagrams of the manufacturer, and that they cannot read usual wiring diagrams. Therefore, very easy installation works will take many hours. You will understand that we neither take the risk to find a reliable specific factory nor the financing of the training of the staff of your favoured factory.

Costs which will arise because you buy missing parts or spare parts at other suppliers will be refunded by us up to the amount of the costs which had been arisen by additional supply (saved expenses). In this case, there would be no right for refund according to the legal guarantee right as long as we have no deadline for supplementary performance or a deadline for supplementary performance has not expired.

So if you have any problems with the installation or operation of one of our products please call us, send us an email, send us the product or take your car to our factory in Bad Segeberg. We are sure to find an appropriate solution for each concern.

With best regards

Your Kufatec GmbH & Co. KG Team

2 Copy Right

Our installation- and removal instructions, installation plans, software and other documentation with texts or pictures are protected by copy right.

A publication or distribution of these documents is only permitted with a written approval of Kufatec GmbH & Co. KG.

3 General Notes

Regarding the development there has especially been paid attention to your personal safety together with the most possible operating comfort, modern design and actual product technologies.

Despite most possible accuracy in case of incorrect installation or use or in case of incorrect operating, it is possible that injuries or damages of property may arise.

Therefore, please read the operating instructions you have received carefully and completely, and keep it with you.

All articles of our production will be checked at 100% — for your safety.

We reserve the right to make technical changes which serve the progress at any time.

Before the installation or startup it may be necessary, depending on the article and purpose of use, to check the legal instructions of each country.

In case of warranty claim the device has to be sent to the seller originally packed together with the sales receipt and a detailed description of the mistake. Please consider the manufacturer's instructions for return (RMA). The legal warranty instructions are valid.

The warranty claim and also the permission for startup will expire in case of:

- unauthorised changes on the device or the accessories which have not been executed or approved by the manufacturer or its partners
- opening of the box
- repair of the device on your own
- incorrect use / no normal use / startup
- influence of force on the device (falling down, wilful damage, accident, etc.)

During the installation please consider all safety and legal instructions. The device may only be installed by trained qualified personnel or persons who are similar qualified.

In case of installation- or function problems please reduce the search of the mistake to approx. 0,5 hours for mechanical works or 1,0 hours for electronic works.

To avoid unnecessary additional work and expenses, please send immediately an inquiry to our technical support with the Kufatec contact form (<http://www.kufatec.de/shop/de/infocenter/>)

Please absolutely mention the following:

- car chassis number
- part number of the add-on kit
- exact description of the problem
- work steps already made

4 Safety instructions

The installation may only be executed by trained qualified personnel. Please execute the installations only in a condition of dead voltage. Here please separate for example the battery from the main power supply and consider the instructions of the car manufacturer.

- In order to not endanger your own driving safety please never use security relevant screws, bolts or other fixation pieces at steering, brake system or other components.
- Connect the device only at 12V wiring system voltage with ground connection to the autobody. This assembly is not allowed for the use in trucks or other cars with 24V wiring system voltage.
- Please avoid the installation of the device at positions where the driving safety or the functional efficiency of other subassembly integrated in the car are restricted.
- This module may only be used together with the following mentioned car types and models; the installation may be executed exclusively by use of the circuit points mentioned in the assembly instructions.
- Kufatec GmbH & Co. KG does not assume liability for damages which are caused by incorrect installation, the use of inapplicable circuit points or the installation into car types and -modules which are not foreseen.
- We would like to draw your attention to the fact that the module processes the data of the MOST-protocol of the car mentioned below. Therefore, during the installation of the module it will be used a model-specific complete system which we as the manufacturer of the mentioned construction line only know partly.
- Especially in case of changes within the same model line and the same year we therefore cannot guarantee the applicability of our construction line in each case. Kufatec GmbH & Co. KG does not assume liability for the applicability of our construction line with changes made by the manufacturer.
- Kufatec GmbH & Co. KG does not assume liability that the installation of the here described component has been permitted according to the guarantee instructions of particular car manufacturers. Therefore, please consider the guidelines for installation and guarantee conditions of your car manufacturer before installation.
- The manufacturer reserves the right to change components without giving reasons.
- Subject to errors and changes

5 Requirements for the determinable operation

Please use the device only in its the corresponding area.

In case of unprofessional and untypical use, installation or modification the permission for operation and the warranty claim will expire.

6 Note

Make sure that there's enough space at the described position. If there is no space please cancel the installation and contact our technical support.

The use of a sound booster is not permitted without registration in the vehicle papers, in the area of the german StVZO. The noise emission of the vehicle is increased by this retrofit. The regulations of the StVZO must be observed. It is therefore recommended to ask for a specific registration option at the responsible TÜV/DEKRA office before retrofitting. Outside Germany, please observe the laws on vehicle licensing applicable in your country.

7 How to connect a cable to another

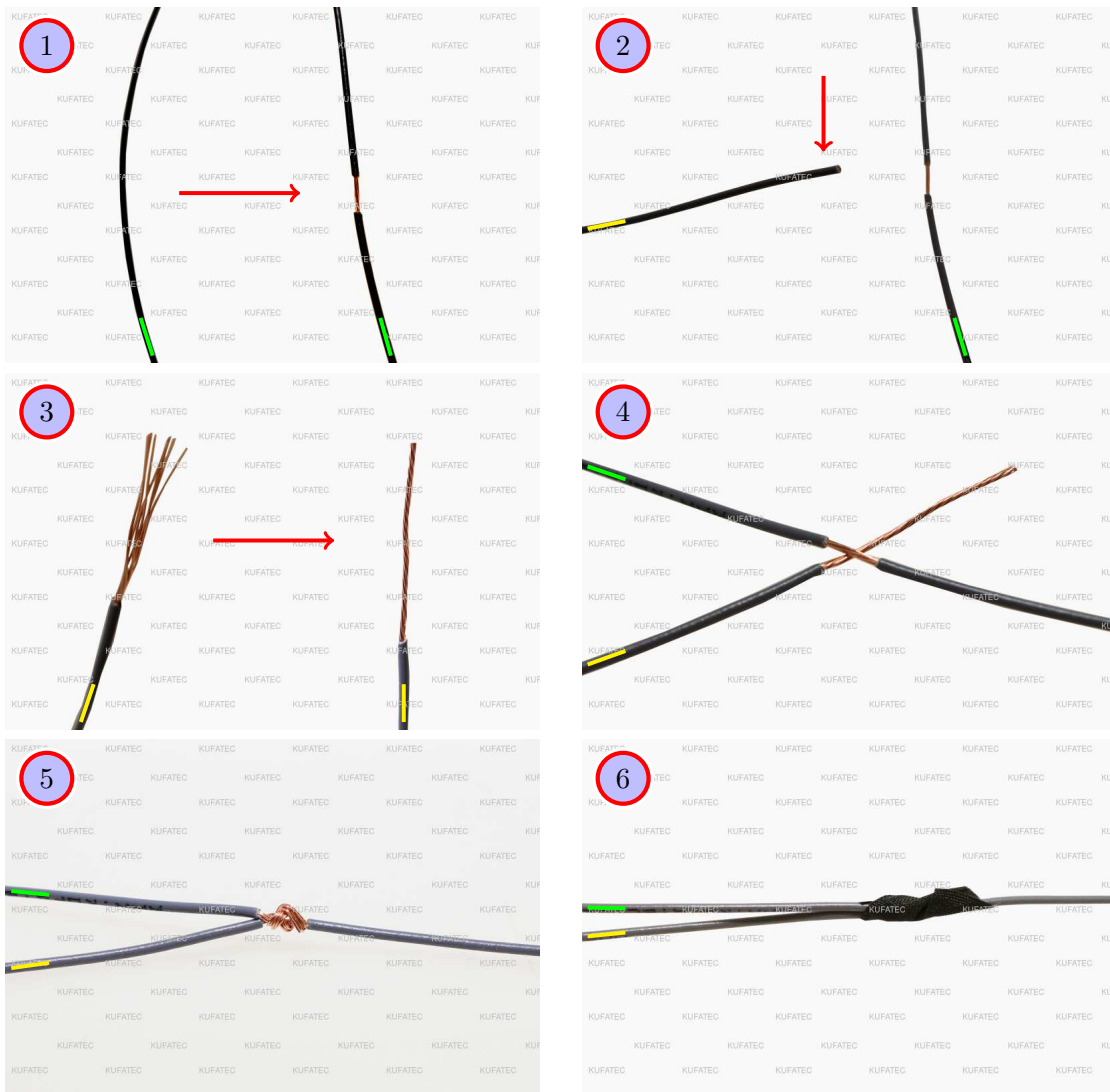

Figure 1: How to connect a cable to another

Table 1: How to connect a cable to another

No.	Work step	Note
1	Take the cable of the vehicle, to which you want to connect, (green marked here) and strip the insulation at one point with a suitable tool (cable stripper/cutter knife).	
2	Now take the cable of the cable set, which you want to connect, (yellow marked here) and strip the insulation at the end.	
3	Twirl the wires of the stripped cable together.	
4	Place the end of the cable you want to connect under the stripped point of the cable of the vehicle...	
5	... and wrap the cable you want to connect around the cable of the vehicle.	
6	Lastly, stick insulating tape around the connection point.	

8 Note Cable Inscription/Color



Figure 2: Cable Inscription

If our cable set consists exclusively of grey wires, connect the wires according to the cable inscription.

9 Assembly Instructions

The following illustration shows the cable routing as well as the position of the individual components.

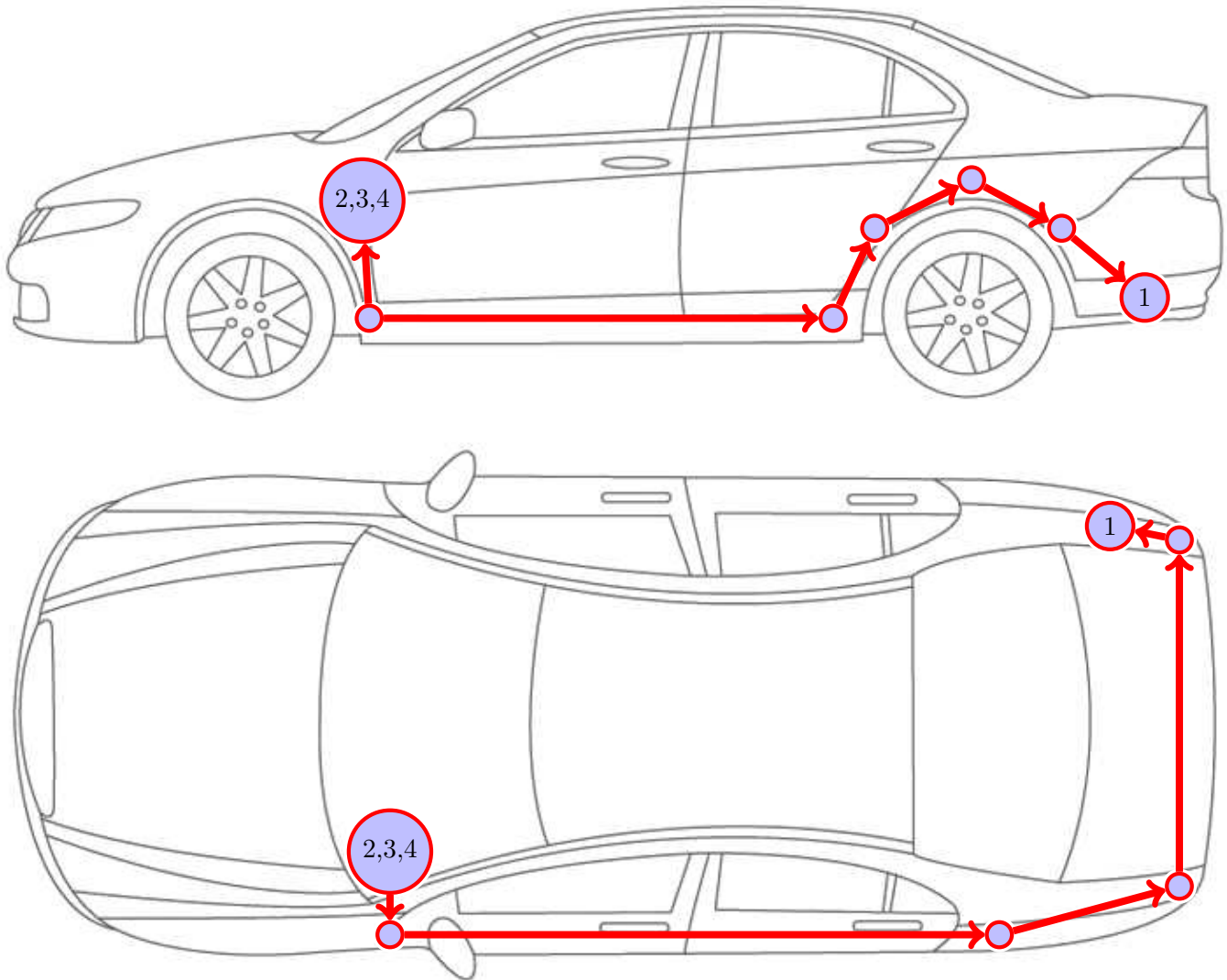

Figure 3: Vehicle overview

- 1 External sound generator incl. mounting plate
- 2 Control unit for engine sound generation
- 3 Sound Booster Pro (module)
- 4 Pushbutton

10 Connection CAN-High / CAN-Low

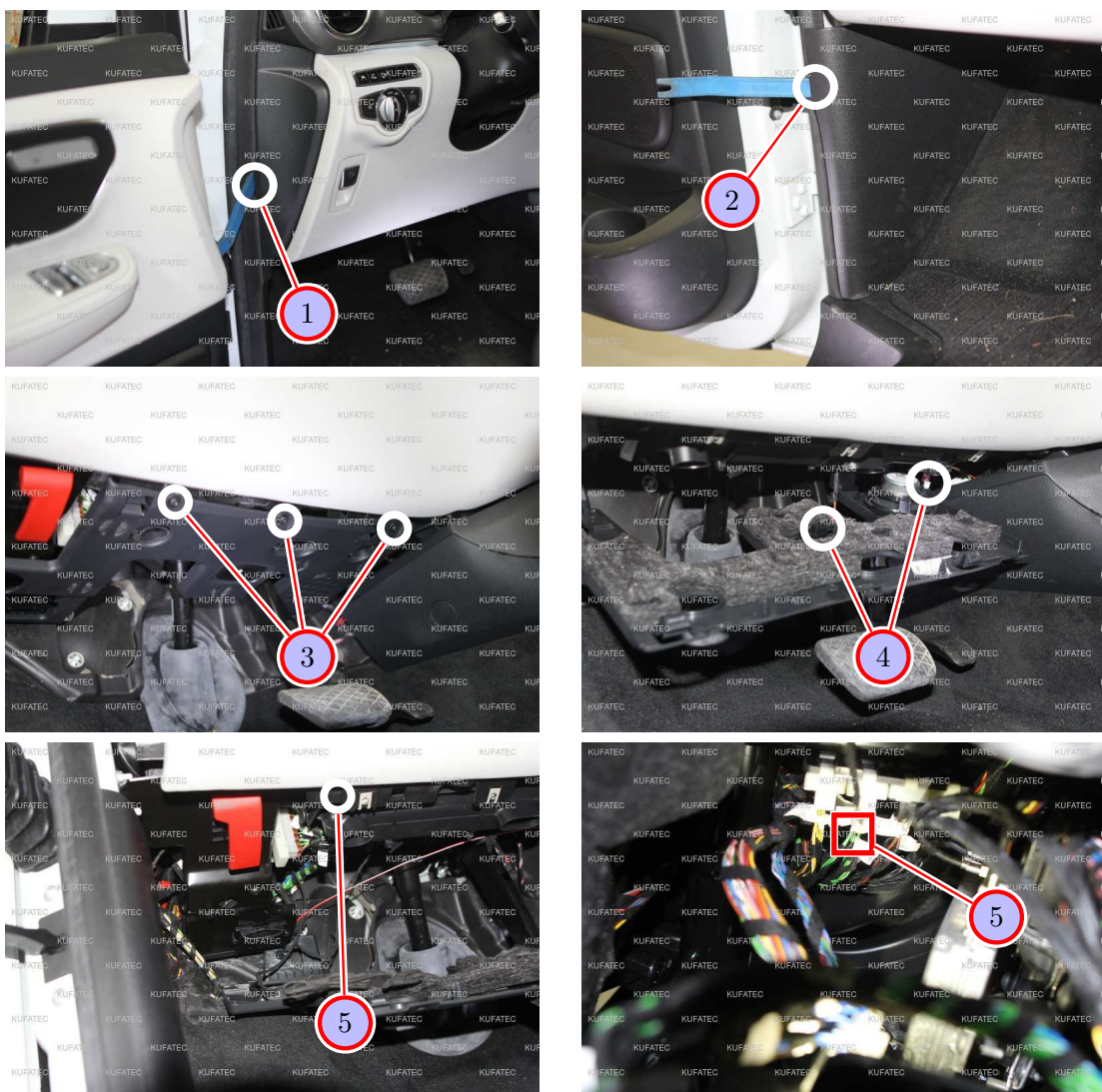

Figure 4: Connection CAN-High / CAN-Low - pictures

Table 2: Connection CAN-High / CAN-Low - instructions

Nr.	Work step	Note
1	Remove the lateral trim panel of the dashboard using a trim tool.	
2	Afterwards remove the lower trim panel of the a-pillar with a trim tool.	
3	Loosen the screws of the lower trim panel of the dashboard and pull it down carefully afterwards.	T25
4	Loosen the two marked plugs and remove the trim panel completely.	
5	The CAN distributor is located far at the top behind the dashboard, to the left of the steering linkage. Connect the 2-pole plug of the cable set to a free plug-in position at the CAN distributor.	
	CAN High (black/white) to green/white (colour of the cable CAN distributor)	
	CAN Low (black/yellow) to green (colour of the cable CAN distributor)	

11 Connection ground / removing center console

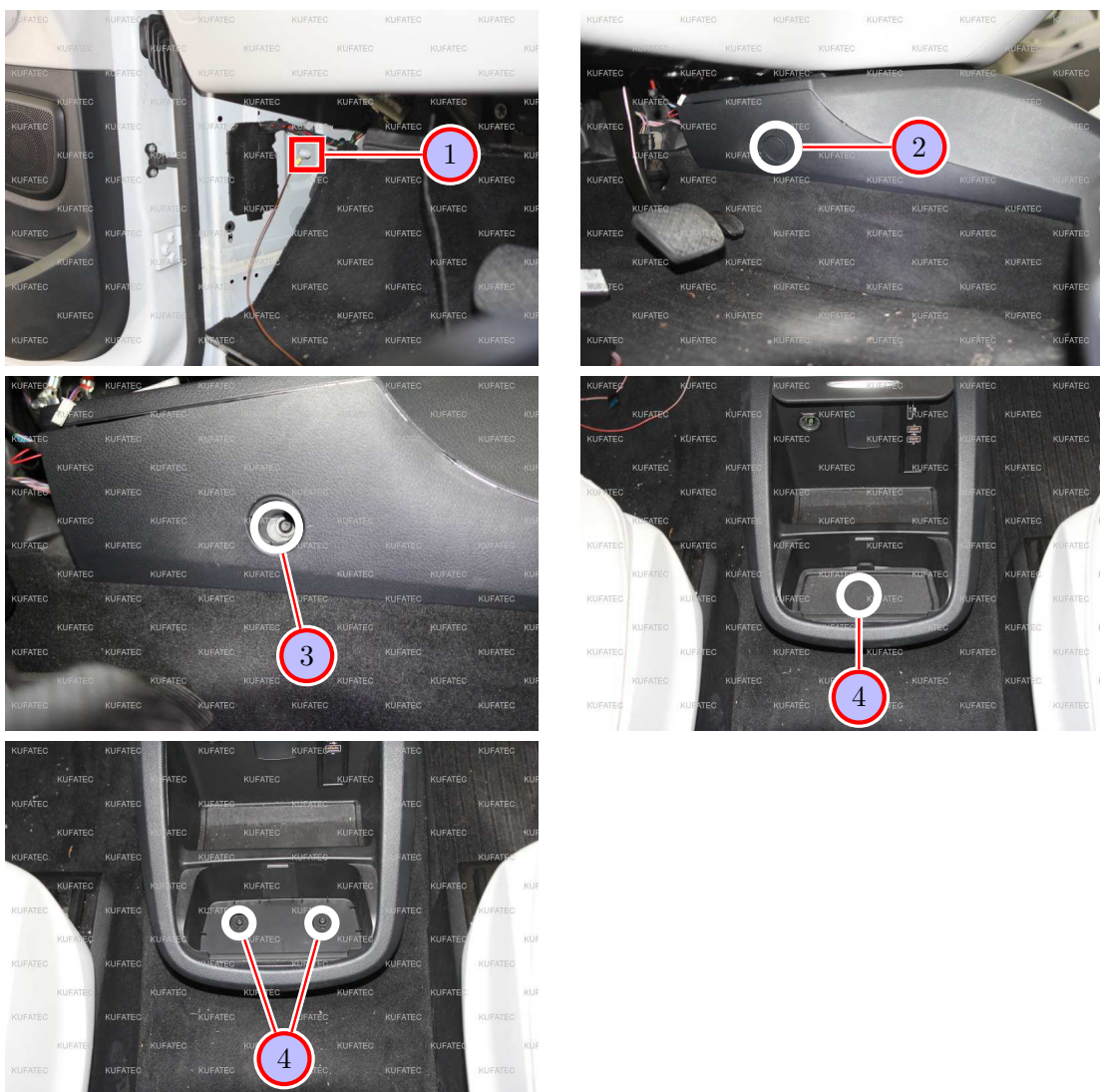

Figure 5: Connection ground / removing center console - pictures

Table 3: Connection ground / removing center console - instructions

Nr.	Work step	Note
1	Connect the ground cable (brown) to the marked ground spot of the a-pillar.	
2	Remove the marked covering of the center console on the driver's side, as well as on the passenger's side.	
3	Afterwards remove the marked screws of the center console on the driver's side, as well as on the passenger's side.	T25
4	Remove the covering out of the oddments tray of the center console and loosen the screws, which are located behind, afterwards. Now pull the center console backward carefully.	T25

12 Connection ignition lead / control unit / module

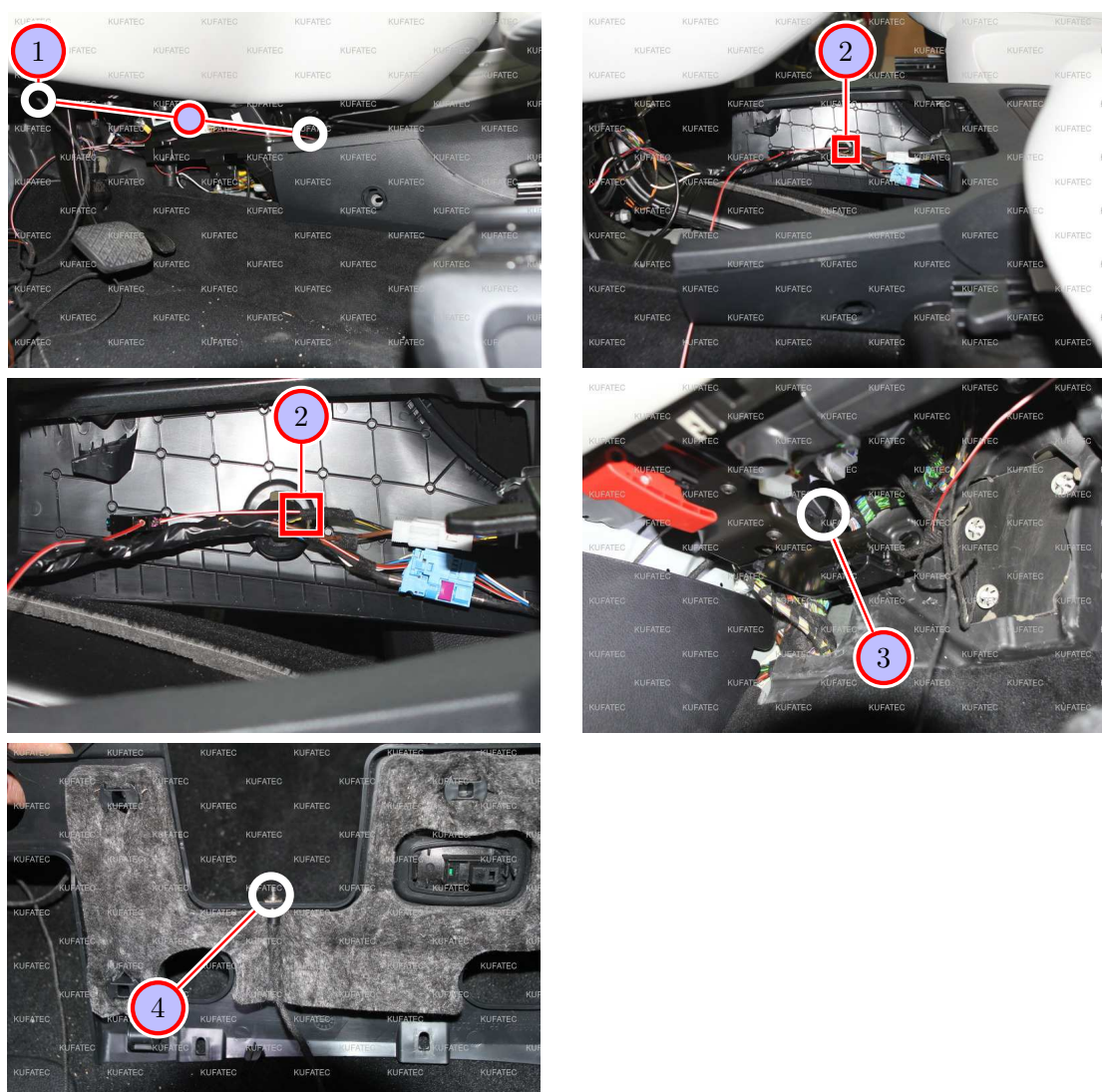

Figure 6: Connection ignition lead / control unit / module - pictures

Table 4: Connection ignition lead / control unit / module - instructions

Nr.	Work step	Note
1	Route the cable for ignition lead (red/white) under the dashboard in the direction of the center console.	
2	Connect the cable for ignition lead (red/white) to the black/yellow cable of the cigarette lighter.	
3	Place the module and the control unit behind the hood release on the beam and attach them with cable ties.	
4	Drill a hole for the pushbutton at the marked position of the trim panel of the dashboard and install it afterwards.	7mm drill

13 Removing sill trims front / rear

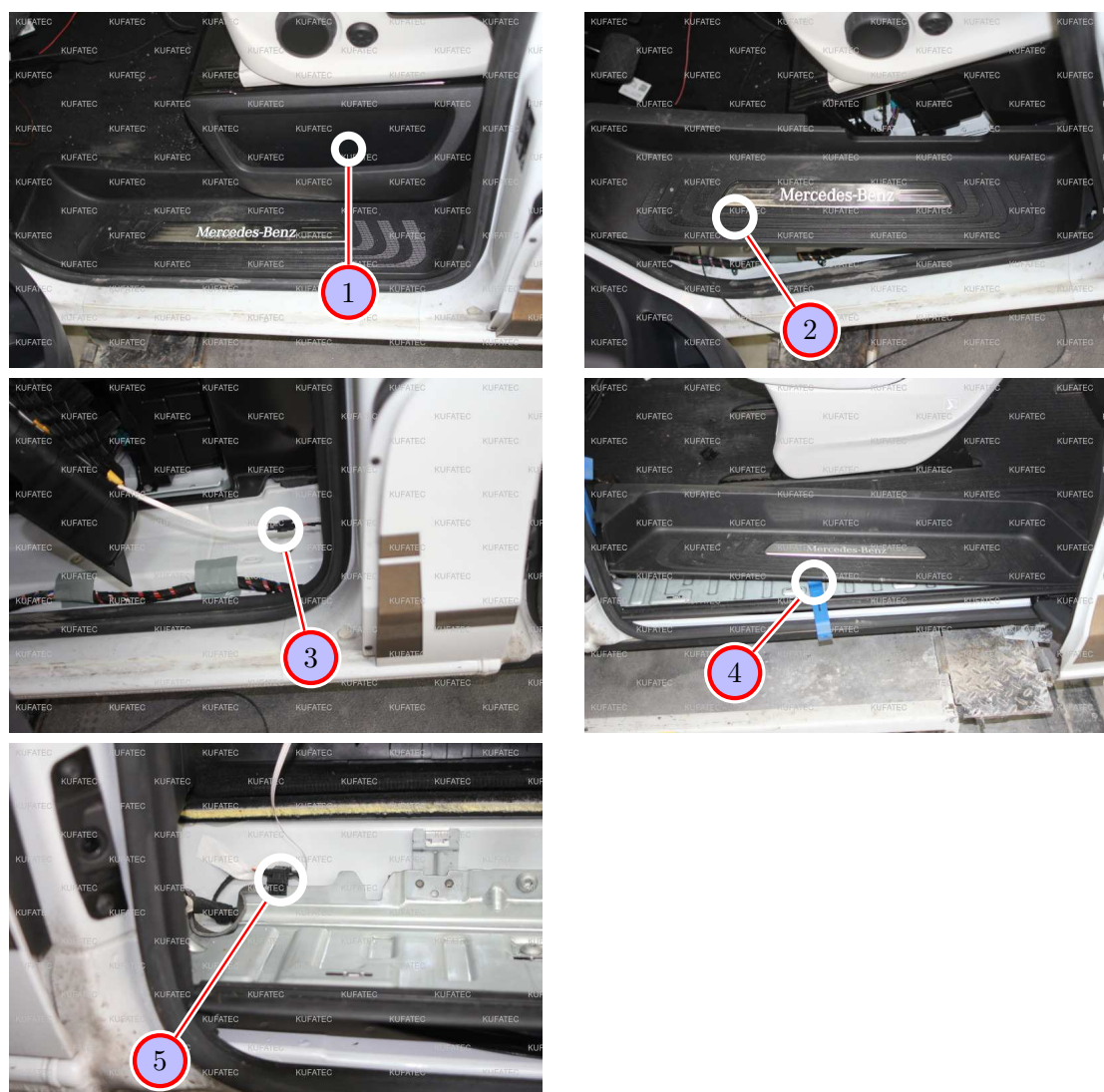

Figure 7: Removing sill trims front / rear - pictures

Table 5: Removing sill trims front / rear - instructions

Nr.	Work step	Note
1	Remove the oddments tray of the driver's seat. It's only plugged in and can be moved off easily.	
2	Loosen the front sill trim with a trim tool and pull it up carefully.	
3	Remove the marked plug from the sill trim and take the entire sill trim out afterwards.	
4	Now remove the rear sill trim with a trim tool and pull it up carefully.	
5	Loosen now the marked plug of the sill trim and take the sill trim out afterwards.	

14 Routing cable sound generator

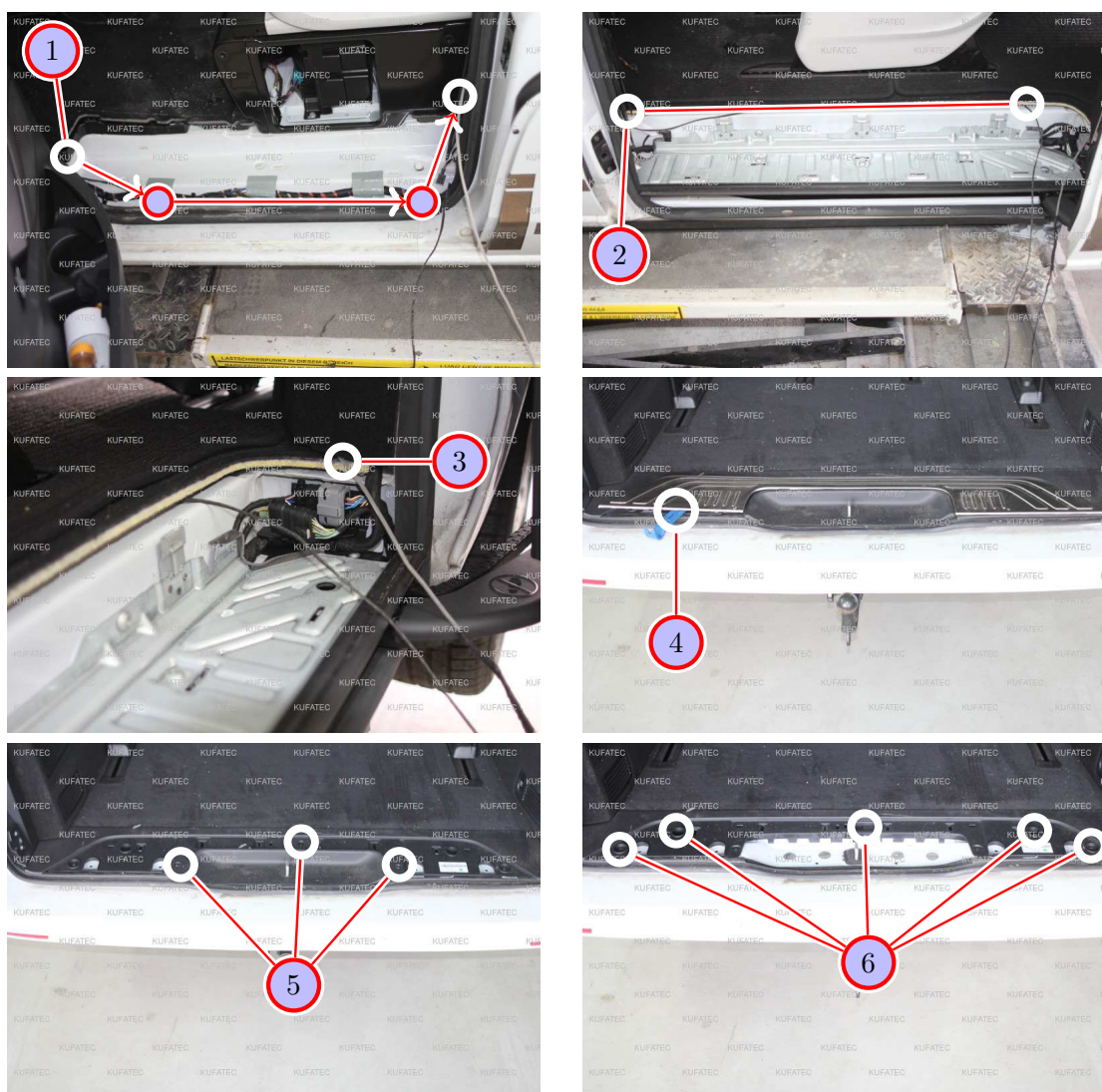

Figure 8: Routing cable sound generator - pictures

Table 6: Routing cable sound generator - instructions

Nr.	Work step	Note
1	Route the cable for the sound generator along the original cable harness and guide it with a pull through aid behind the trim panel of the b-pillar backward.	
2	Pull the cable for the sound generator further through and route it below the carpet to the c-pillar.	
3	Afterwards push the cable with a pull through aid under the carpet in the trunk.	
4	Remove the trunk sill protection with a trim tool.	
5	Loosen the marked screws of the middle covering and take it out afterwards.	
6	Now remove all marked screws of the lower covering and take it out afterwards.	

15 Routing cable sound generator to the underbody

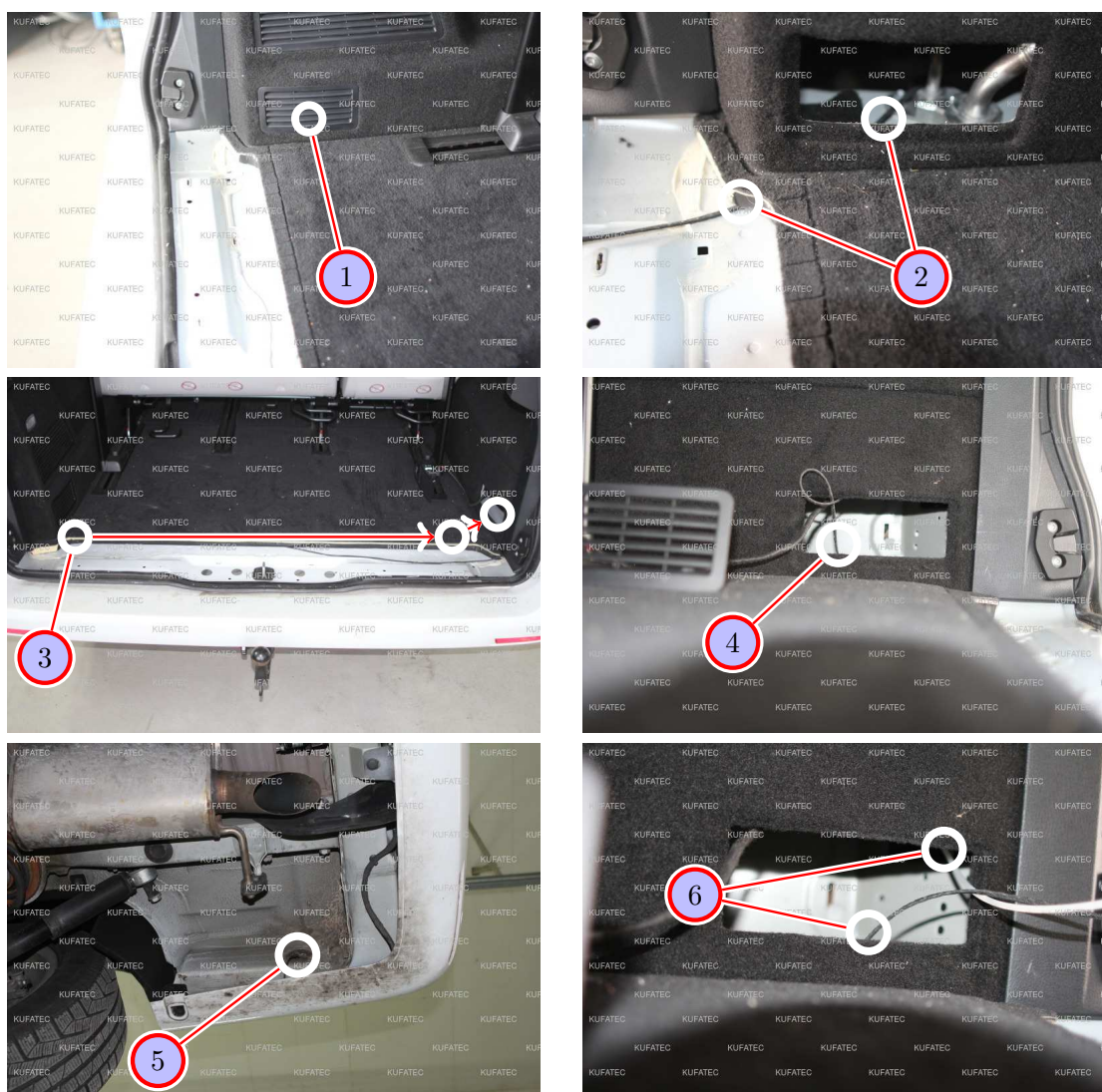

Figure 9: Routing cable sound generator to the underbody - pictures

Table 7: Routing cable sound generator to the underbody - instructions

Nr.	Work step	Note
1	Remove the marked covering in the trunk on the left.	
2	Pull the cable for the sound generator behind the side trim panel further through.	
3	Route the cable further below the carpet to the right side in the trunk.	
4	Take the covering out of the right side trim panel in the trunk on the right and pull the cable for the sound generator behind the side trim panel.	
5	Push a pull through aid through the marked car body opening in the direction of the trunk.	
6	Now pull the pull through aid further through the opening of the side trim panel. Connect now the pull through aid with the cable for the sound generator and pull the cable down through afterwards.	

16 Installation sound generator

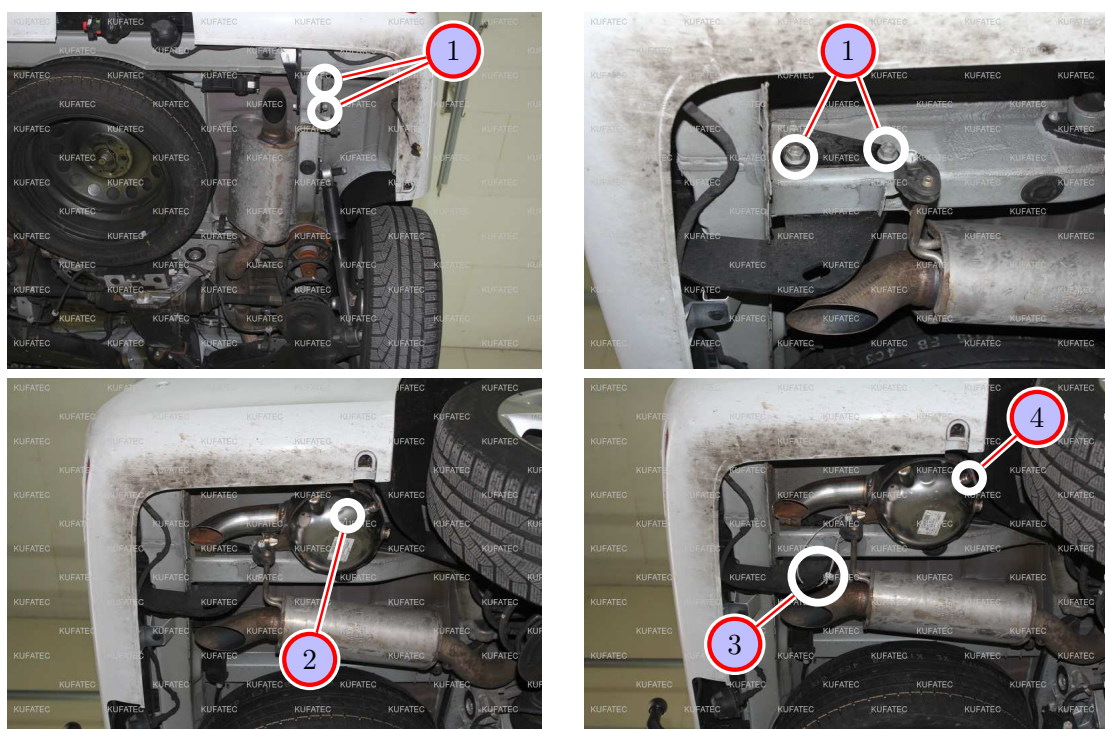

Figure 10: Installation sound generator - pictures

Table 8: Installation sound generator - instructions

Nr.	Work step	Note
1	Loosen the two marked screws of the impact protection.	18er socket
2	Install the sound generator with the two loosened screws at the car body.	18er socket
3	Now mount the safety rope at the impact protection as well as at the sound generator.	
4	Connect now the down routed cable to the sound generator.	

17 Important Information Sound Booster

Please use for the fixation of the Sound Booster suitable high tensile screws. In order to avoid loosening of the screws by vibration please make the screws safe with appropriate factory material e.g. Threadlock. Please additionally check the stability of the Sound Booster regularly and if necessary retighten the screws. In case of no consideration we do not assume liability for possible damages. After successful installation we recommend to cover the sound generator with a zinc spray. Make sure that you cover the opening of the sound generator so that no zinc spray can't get inside the sound generator.

As additional safety the delivered steel cable and the retaining clips have to be tightened on the Sound Booster as well as at a suitable position in the car. This safety cable is an additional security should the tightening screws should be released by vibration.

List of Figures

1	How to connect a cable to another	6
2	Cable Inscription	7
3	Vehicle overview	8
4	Connection CAN-High / CAN-Low - pictures	9
5	Connection ground / removing center console - pictures	10
6	Connection ignition lead / control unit / module - pictures	11
7	Removing sill trims front / rear - pictures	12
8	Routing cable sound generator - pictures	13
9	Routing cable sound generator to the underbody - pictures	14
10	Installation sound generator - pictures	15

List of Tables

1	How to connect a cable to another	6
2	Connection CAN-High / CAN-Low - instructions	9
3	Connection ground / removing center console - instructions	10
4	Connection ignition lead / control unit / module - instructions	11
5	Removing sill trims front / rear - instructions	12
6	Routing cable sound generator - instructions	13
7	Routing cable sound generator to the underbody - instructions	14
8	Installation sound generator - instructions	15